

Cromwell Concrete Products, Inc.

NOTES

1. The 6" handhole at center of bolt circle projects into a 6" wide slot 28" high thru the base.
2. Final 28 day concrete strength to be ~~500 psi.~~ **5000 PSI**
3. Fabricator to obtain 1" x 33" anchor bolts, SC010050 from company stock.
4. Concrete and concrete design shall be in accordance with ACI Code 318-1986.
5. Manufacturer's identification and month/year when manufactured shall be legibly marked in/on concrete within 3" of the top.

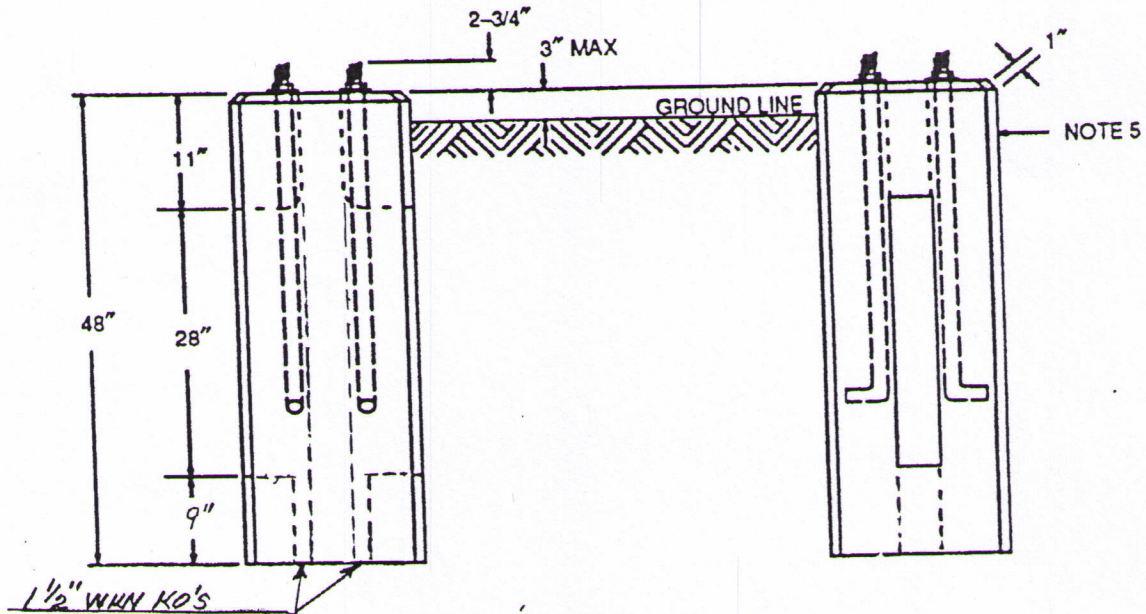
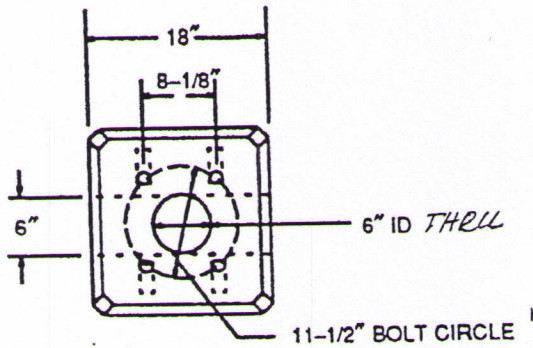

WGT. 950 Lbs.

ORIGINAL	BASE - STREET LIGHT - PRECAST CONCRETE - STANDARD		
B/13/75			
APPROVED	NORTHEAST UTILITIES	MATERIAL SPECIFICATION	SPC B-159
B/1/91			
FST/MS/US			5