

USA

NEW

HYDRAULIC
DRIVEN HEADS

BL1/EX

FAE GROUP WORLDWIDE

FAE GROUP SPA

Zona Produttiva, 18 | 38013 Fondo (TN) - Italy
Ph. +39 0463 840000 | Fax +39 0463 840099
info@fae-group.com | www.fae-group.com

FAE USA INC.

Oakwood Industrial Park | 5321 Rafe Banks Dr. | Flowery Branch, GA 30542 - United States
Ph. +1 770 407 2014 | +1 877-FAEUSA-1 | Fax. +1 770 338 4508
info@faeusa.com | www.faeusa.com

FAE AUSTRALIA PACIFIC PTY LTD

485 Hammond Rd | Dandenong South | 3175 VIC - Australia
Ph. +61 3 9706 4088
info@fae-ap.com.au | www.fae-ap.com.au

FAE CENTRAL EAST EUROPE GmbH

Poststraße 2 | 14542 Werder/OT Glindow - Germany
Ph. +49 (0) 3327 565700 | Fax +49 (0) 3327 565700
info@faecee.com | www.faecee.com

FAE FRANCE SAS

84, rue du Montmurier | 38540 Grenay - France
Ph. +33 04 74 95 9000 | Fax +33 04 74 95 9005
info@fae-france.com | www.fae-france.com

FAE RUSSIA | ООО ФАЕ РУССИА

101 Pogodina Str. | 143302 Naro-Fominsk, Moscow region - Russian Federation
Российская Федерация | 143302, Московская область | г. Наро-Фоминск | ул. Погодина, 101
Ph. +7 495 763 9331 | info@fae-russia.com | www.fae-russia.com

PRIMETECH SHREDDING EQUIPMENT LTD.

110 Saskatchewan Ave | Spruce Grove, AB, T7X 0V5 - Canada
Ph. +1 780-948-8882 | Fax +1 780-948-8886
info@prime-tech.com | www.prime-tech.com



ADVANCED
SHREDDING
TECHNOLOGIES

fae-group.com



LAND CLEARING

NEW

BL1/EX



13-34 gal/min



5 in



4-7.5 t

BL1/EX

NEW PROFESSIONAL MULCHER FOR EXCAVATORS FROM 4 TO 7.5 T WITH BITE LIMITER TECHNOLOGY

FAE introduces a new line of professional mulchers for excavators equipped with Bite Limiter technology. Special steel limiter rings control the depth of blade action, reducing the demand for power, thus guaranteeing speed and exceptional performance. **The BL1/EX** (for 4-7.5 t excavators) has a 31.5 in working width and can mulch material up to 6 inches in diameter. The piston engine (with manually controlled variable displacement) make this mulcher easy to use on different excavators with different hydraulic flow rates. The BL1/EX has a rotor equipped with a heat-treated forged steel tooth holder, along with Type E reversible blades. This light, compact mulcher is easy to maneuver and perfect for various types of forestry work.

STANDARD EQUIPMENT: 17/34cc variable manual displacement hydraulic piston motor with relief and anticavitation valve, flow control system valve, safety and anticavitation valve, motor enclosed in the frame, belt transmission, bulkhead for hydraulic connections, front trap door with mechanical adjustment, Bite Limiter rotor.

OPTIONS: Diverter valve (plug and play), hydraulic front door, dedicated rear deflector, bolt on fixed heel and customized attachment bracket with pins.

1 BITE LIMITER
SUPERIOR PERFORMANCE ON SPECIFIC APPLICATIONS

2 LIGHT AND COMPACT
PERFECT FOR MIDSIZE AND SMALL EXCAVATORS

3 SAFER
ADJUSTABLE REAR DEFLECTOR

4 DETAILS MAKE THE DIFFERENCE
HYDRAULIC PISTON MOTOR AND CUSTOM MADE ATTACHMENT BRACKET

MODEL	Flow rate (gal/min)		Pressure (PSI)		Excavator weight (t)		Working width (in)	Weight (lbs)	Max. shredding diameter (in)	No. teeth E
	min	max	min	max	min	max				
BL1/EX - 75	13	34	2611	5076	4	7.5	31	783	5	14

Data refers to machine as standard. The technical data in this catalog may be altered without prior notice.

FEATURES

ATTACHMENT BRACKET (WITH OPTIONAL PINS)

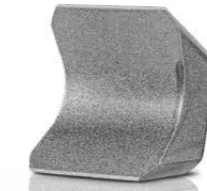
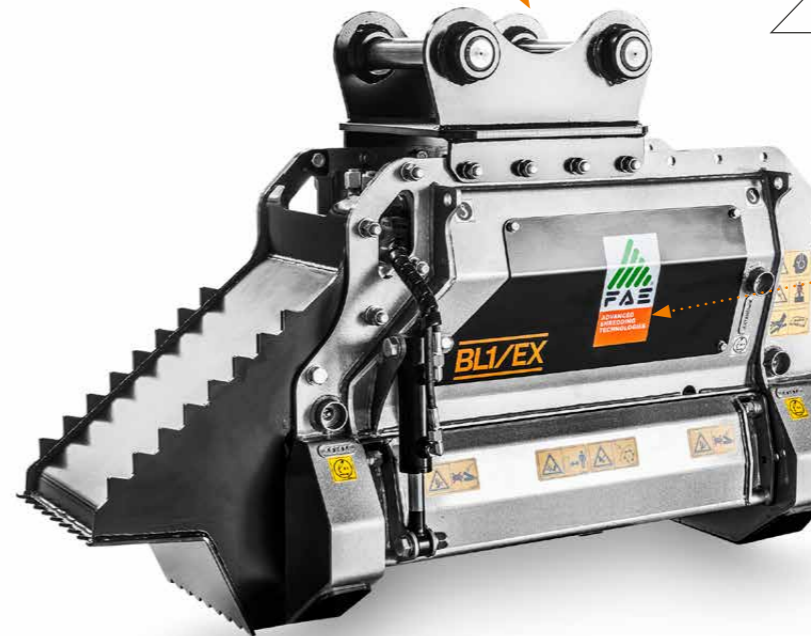

Reversible E Blade

Standard



E/HD Carbide Blade

Optional

HYDRAULIC PISTON MOTOR WITH MANUAL DISPLACEMENT CONTROL

Integrated relief valve and anticavitation valve.



HYDRAULIC FRONT TRAP DOOR

Helps contain debris and achieves finer sizing (Optional).

CUSTOM MADE HEEL

To move and reposition material.



BITE LIMITER ROTOR

Special steel limiter rings control the depth of blade action.

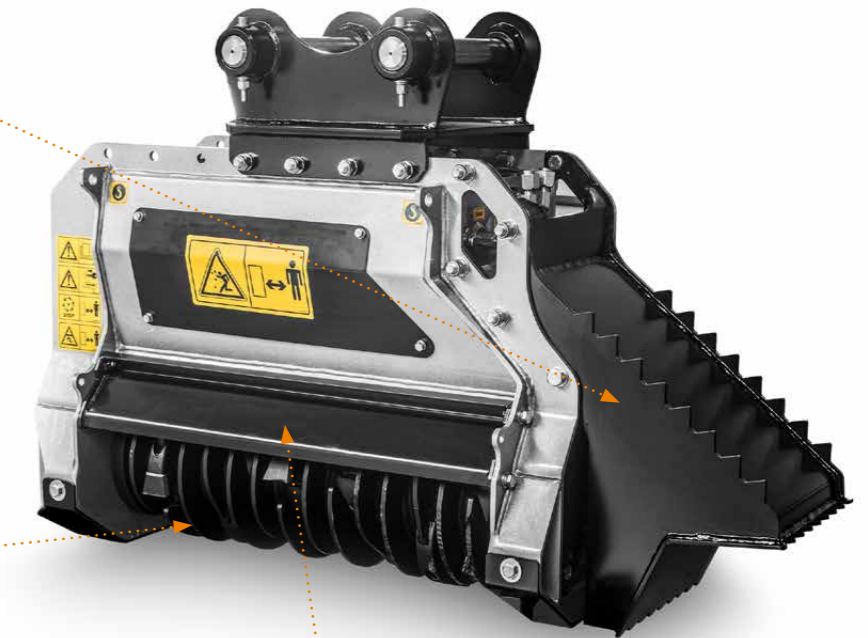

ADJUSTABLE REAR DEFLECTOR

Controls mulched material output for greater safety (Optional).

DETAILS MAKE THE DIFFERENCE